

AUSMUS MAPLE KNOLL 1ST ADDITION

THE SOUTH LINE OF OUTLOT B OF THE RECORDED PLAT OF AUSMUS MAPLE KNOLL IS ASSUMED A BEARING OF S 89° 45' 26" W

"OFFICIAL PLAT"

KNOW ALL MEN BY THESE PRESENTS: That Ralph W. Ausmus and Dorothy J. Ausmus, husband and wife, owners and proprietors of the following described property situate in the County of Pine, State of Minnesota, to-wit:

Outlot B of the recorded plat of AUSMUS MAPLE KNOLL, Pine County, Minnesota, located in part of Government Lots 2 and 3, Section 25, Township 39, Range 22.

Have caused the same to be surveyed and platted as AUSMUS MAPLE KNOLL 1ST ADDITION, and do hereby donate and dedicate to the public for public use forever the lanes and the drainage and utility easements as shown on this plat.

In witness whereof, Ralph W. Ausmus and Dorothy J. Ausmus, husband and wife, have hereunto set their hands and affixed their seals this 4th day of January, 1983, A.D.

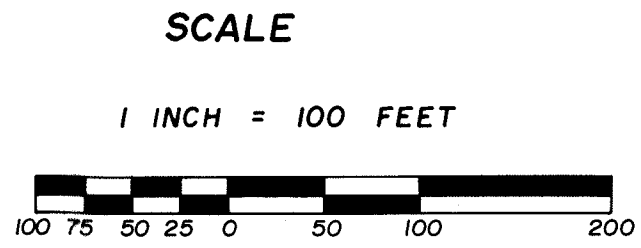

o DENOTES 1/2 INCH IRON PIPE WITH PLASTIC CAP MARKED R. L. S. NO. 8195

DRAINAGE AND UTILITY EASEMENTS ARE SHOWN THUS:



BEING 10 FEET IN WIDTH AND ADJOINING LOT LINES UNLESS SHOWN OTHERWISE

KEY MAP

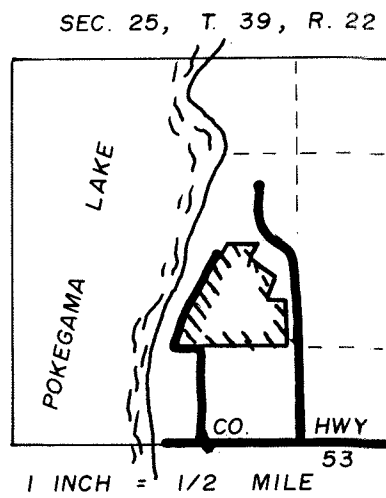

1 INCH = 1/2 MILE

SEC. 25, T. 39, R. 22

POKEGAMA LAKE

CO. HWY. NO. 53

1 INCH = 1/2 MILE

SEC. 25, T. 39, R. 22

POKEGAMA LAKE

CO. HWY. NO. 53

1 INCH = 1/2 MILE

SEC. 25, T. 39, R. 22

POKEGAMA LAKE

CO. HWY. NO. 53

1 INCH = 1/2 MILE

SEC. 25, T. 39, R. 22

POKEGAMA LAKE

CO. HWY. NO. 53

1 INCH = 1/2 MILE

SEC. 25, T. 39, R. 22

POKEGAMA LAKE

CO. HWY. NO. 53

1 INCH = 1/2 MILE

SEC. 25, T. 39, R. 22

POKEGAMA LAKE

CO. HWY. NO. 53

1 INCH = 1/2 MILE

SEC. 25, T. 39, R. 22

POKEGAMA LAKE

CO. HWY. NO. 53

1 INCH = 1/2 MILE

SEC. 25, T. 39, R. 22

POKEGAMA LAKE

CO. HWY. NO. 53

1 INCH = 1/2 MILE

SEC. 25, T. 39, R. 22

POKEGAMA LAKE

CO. HWY. NO. 53

1 INCH = 1/2 MILE

SEC. 25, T. 39, R. 22

POKEGAMA LAKE

CO. HWY. NO. 53

1 INCH = 1/2 MILE

SEC. 25, T. 39, R. 22

POKEGAMA LAKE

CO. HWY. NO. 53

SIGNED
Ralph W. Ausmus
RALPH W. AUSMUS

SIGNED
Dorothy J. Ausmus
DOROTHY J. AUSMUS

State of Minnesota
County of Pine

The foregoing instrument was acknowledged before me this 4th day of January, 1983, A.D., by Ralph W. Ausmus and Dorothy J. Ausmus.

Rosemarie Rude
Notary Public, Pine County, Minnesota
My Commission Expires September 22, 1986

I hereby certify that I have surveyed the property described on this plat as AUSMUS MAPLE KNOLL 1ST ADDITION; That this plat is a correct representation of said survey; That all distances are correctly shown in feet and decimals of a foot; That all monuments have been correctly placed in the ground as shown; That the outside boundary lines are correctly designated; That there are no wet lands or public highways to be designated on the plat other than as shown thereon.

Morrell B. Rude
Morrell B. Rude
Land Surveyor Minnesota Registration No. 8195

State of Minnesota
County of Pine

This Surveyors Certificate was subscribed and sworn to before me, a Notary Public, this 25th day of October, 1982, A.D., by Morrell B. Rude, Registered Land Surveyor.

Rosemarie Rude
Notary Public, Pine County, Minnesota
My Commission Expires September 22, 1986

This plat was approved as to form and execution on this _____ day of January, 1983, A.D.

John K. Carlson
County Attorney, Pine County, Minnesota

I hereby certify that the taxes for the year 1983 on the property described herein are paid.

Justin A. Blahnik
County Treasurer, Pine County, Minnesota

I hereby certify that the taxes for the year 1982 and all prior years on the property described herein are paid.

Lawrence A. Curran
County Auditor, Pine County, Minnesota

The plat of AUSMUS MAPLE KNOLL 1ST ADDITION was accepted and approved by the County Board of Pine County, Minnesota, at a regular meeting thereof, held this 5 day of January, 1983, A.D.

COUNTY BOARD OF PINE COUNTY

By: Earl K. Koehler Chairman By: Lawrence A. Curran Auditor

I hereby certify that the plat of AUSMUS MAPLE KNOLL 1ST ADDITION was filed in this office on the 13 day of January, 1983, A.D., at 9 o'clock A. M., Micro Number 276097.

Frances Southwick
County Recorder, Pine County, Minnesota

