

DESCRIPTION:

All of the Southeast quarter (SE¹/₄) of the Southwest quarter (SW¹/₄) of Section Twenty-eight (28) Township thirty-nine (39) South of Range Twenty-one (21) West of the Fourth Principal Meridian, except that portion of the (SE¹/₄) of SW¹/₄ of said Section, Town and Range, deeded to Fred A. Hodge, also all of lot one (1) of said Section Town and Range, except that portion heretofore deeded to Lake Superior and Mississippi Railway Company for a right of way and that portion deeded, deeded to Fred A. Hodge.

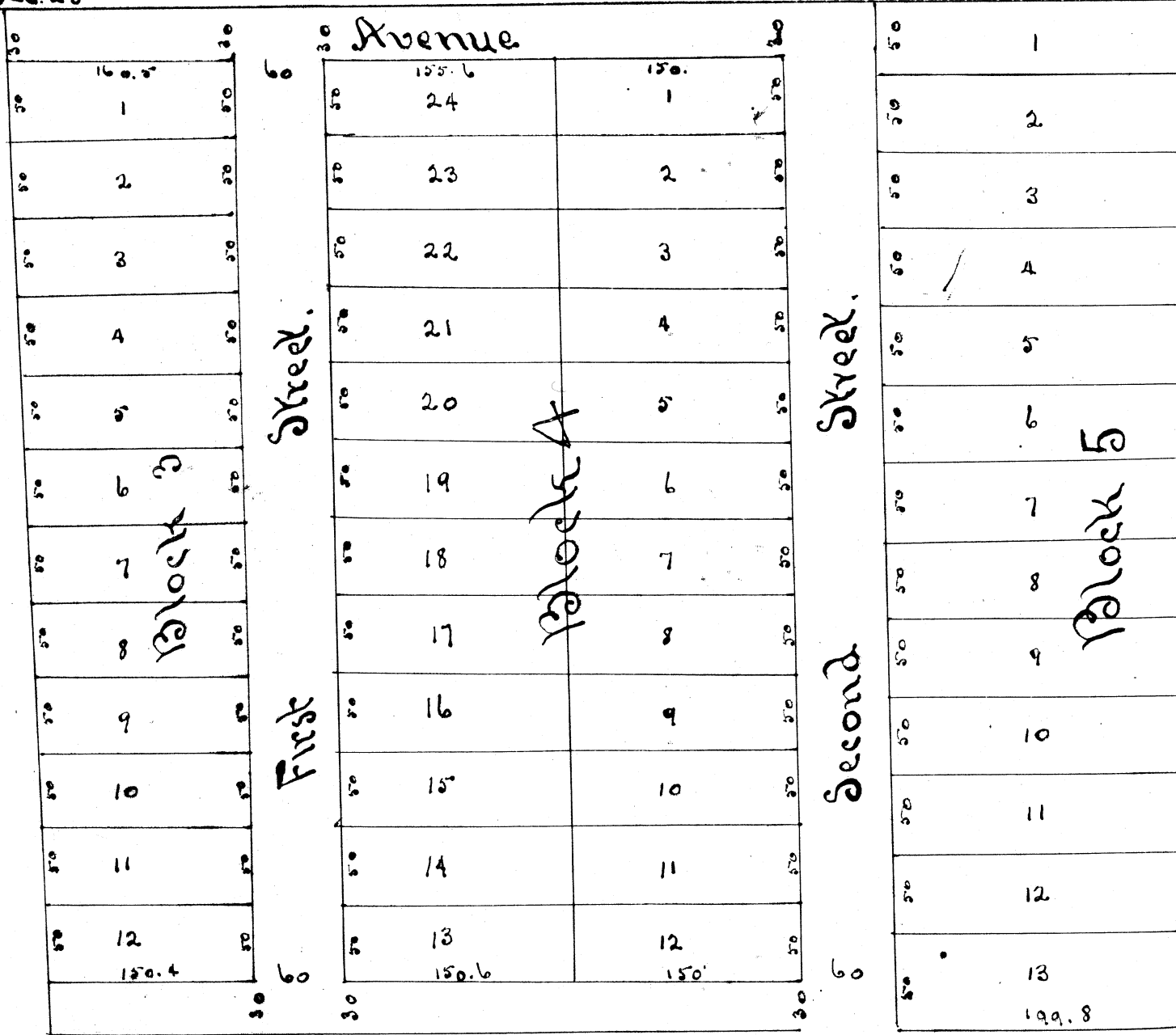

State of Minnesota } ss.
 County of Pine }
 I, Robert Blankenship, do hereby certify that at the request of William F. Underwood administrator of the estate of Eugene Underwood deceased I have surveyed and plotted Royal Park Addition to Pine City according to the plat thereof hereto annexed. That the same is a true and correct plat of said Addition that the same covers all of the Southeast quarter (SE¹/₄) of the Southwest quarter (SW¹/₄) of Section Twenty-eight (28) Township thirty-nine (39) South of Range Twenty-one (21) West of the Fourth Principal Meridian except that portion heretofore deeded to Fred A. Hodge, also all of lot one (1) of said Section Town and Range except that portion heretofore deeded to Lake Superior and Mississippi Ry. Co. for a right of way and that portion deeded to A. C. Keller and that portion deeded to Fred A. Hodge. Further that I have placed and set separate monuments as herein shown for reference for future surveys. Robert Blankenship (Seal)
 Surveyor.

State of Minnesota } ss.
 County of Pine }
 On this 30th day of December A.D. 1897, before me personally came and appeared Robert Blankenship, to me known to be the person described in and who presented the foregoing certificate and acknowledged to me that he executed the same freely and voluntarily. Witness my hand and official seal this day and year above named.
 J. H. L. Roberts
 Notary Public, Pine County, Minnesota
 I hereby certify that I have made a careful examination of the survey and find that of Royal Park Addition to Pine City and find the same to be correct that the boundary lines of land plotted are correct by shape, that the size of all the lots here are as granted upon the plat and the monuments shown on the plat have been correctly placed.
 John D. Miles
 Deft. Co. Surveyor.

State of Alabama } ss.
 County of Jefferson }
 I, William F. Underwood, administrator of the estate of Eugene Underwood deceased, do hereby certify that Eugene Underwood in all the time of his death was the proprietor and owner of the real estate herein described that as such administrator I have obtained the authority and consent of the Probate Court of Pine County, to subdivide into lots and blocks and lay out into streets and alleys the following described tracts and parcels of land situated lying and being in the County of Pine and State of Minnesota, to wit: All of the Southeast quarter (SE¹/₄) of the Southwest quarter (SW¹/₄) of Section number twenty-eight (28) Township thirty-nine (39) South of Range Twenty-one (21) West of the Fourth Principal Meridian except that portion heretofore deeded to Fred A. Hodge by the undersigned as such administrator, also all of lot one (1) of said Section Town and Range, except that portion heretofore deeded to Lake Superior and Mississippi Railway Company for a right of way, and that portion deeded to A. C. Keller and that portion deeded to Fred A. Hodge. Further that as such administrator I have caused all that portion of the tracts above described to be subdivided into lots and blocks and streets and alleys as shown upon the annexed plat, and I do hereby declare with said plat as Royal Park Addition to Pine City and I hereby dedicate to public use forever the streets and alleys as the same are designated on said plat.
 In presence of
 Jno. H. Keeley
 W. C. Baldwin
 William F. Underwood (Seal)
 Administrator of the estate of Eugene Underwood deceased.

State of Alabama } ss.
 County of Jefferson }
 It is known that on this 23rd day of December A.D. 1897, before me personally came and appeared William F. Underwood to me well known to be the administrator of the estate of Eugene Underwood deceased and the same person described in and who presented the foregoing certificate of platting and said William F. Underwood thereupon acknowledged to me that he executed the same as such administrator freely and voluntarily and for the use and purposes therein expressed and upon the authority and approval of the Probate Court of Pine County, Minnesota.
 Witness my hand and official seal the day and year above named.
 Jno. H. Keeley (Seal)
 Notary Public, Jefferson County, Alabama.
 Commission expires Dec. 16, 1900.

State of Minnesota } ss.
 County of Ramsey }
 It is known that I, Edward Killrich, Judge of the Probate Court in and for the County of Ramsey and State of Minnesota, do hereby approve of the annexed platting by the administrator of the estate of Eugene Underwood deceased.
 In witness whereof I have hereunto set my hand and official seal this 29th day of December A.D. 1897.
 E. Killrich
 Judge of Probate Court
 Attest
 G. B. Abinger
 Clerk of Probate Court
 J. O. 23333.

I hereby certify that taxes for the year 1897 on the lands described within are paid.
 G. J. Abrecht
 COUNTY TREASURER
 I have paid and transfer entered this 4th day of January 1898.
 J. H. Keeley
 County Auditor.

That I have paid and transfer entered this 4th day of January 1898.
 J. H. Keeley
 County Auditor.

HAZEL PARK ADDITION

(Underwood's Add'n)