

Pine County Land Department ♦ 2018 Tax Forfeit Land Auction



TRACT #12 ARLONE TOWNSHIP

PID - 01.0200.004

North 460 feet of the E 1/2 of NW 1/4 of NW 1/4
27-41-19 6.97 acres

Appraised Value: \$9,900

Property Description:

39298 State Hwy 48

6.97 acres total, has approximately:

2 acres of upland mixed forest, 3 acres of wetlands, and 1 acre open upland areas.

Property has a creek running through it.

Demolition of building(s)/property clearances needed



SOLED

www.co.pine.mn.us



Driving Directions

From the intersection of State Highway 48 and County Road 21 (Cloverdale Rd) in Cloverdale, drive about 800 feet east on State Highway 48. Driveway and property is to the south.

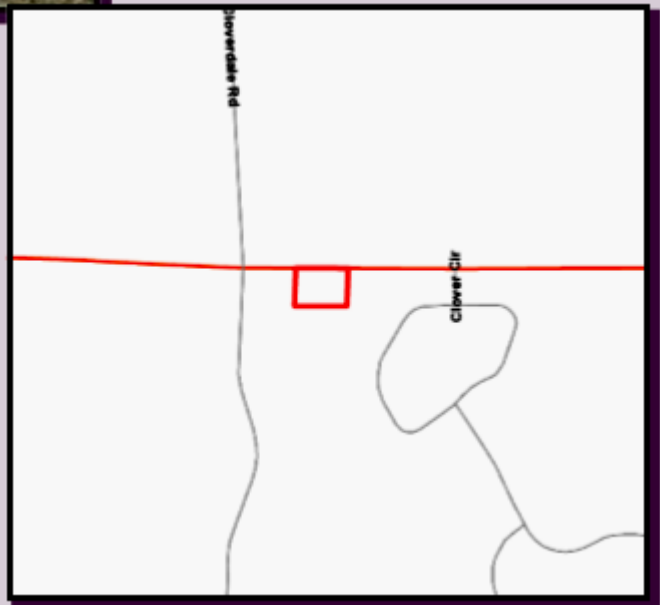

Arlone Township: 320-384-6246

Pine County Zoning: 320-216-4220

Maps are for informational purposes only and may not be exact. All properties sold "as is" with no guarantees. Buyers are encouraged to thoroughly research properties before purchase. If improvements are intended check with local planning and zoning authorities, and if wetlands exist contact Pine County Zoning. Acreage descriptions are approximate estimates. Please Note: Pine County makes no representations, warranties, nor guarantees with respect to access to tax forfeited lands sold. Subject to all existing easements of record and rights of way.

For further information please contact the Pine County Land Department at 320-216-4225.