



TRACT #14 BROOK PARK TOWNSHIP

PID - 06.0251.000

W 1/2 of W 1/2 of SW 1/4 of SE 1/4

28-40-22 10 acres

Appraised Value: \$24,500

Property Description:

25541 Monument Rd

10 acres consisting of mostly upland forest.

Timber value \$3,700



SOLD

www.co.pine.mn.us



Driving Directions

From the intersection of State Highway 23 and County Road 126 (Monument Road) west of Brook Park, drive about 1.8 miles south on County Road 126 (Monument Road). Road will curve to the west. Drive west for about 1/2 a mile. Property is to the north.

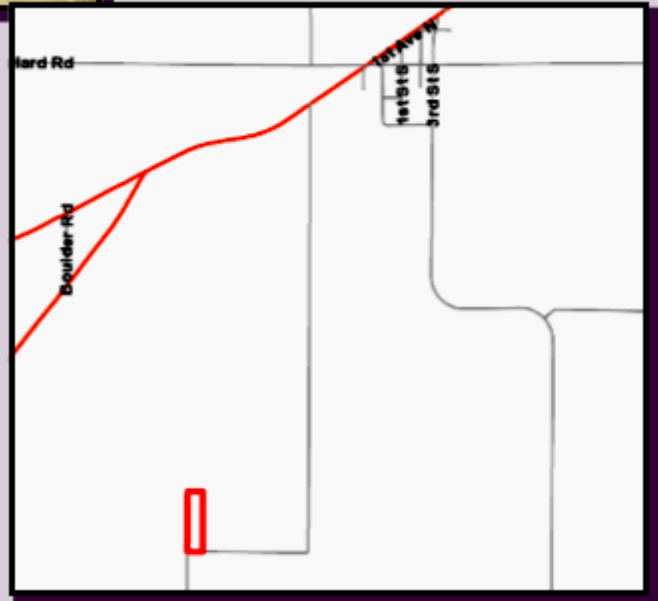

Brook Park Township: 320-679-4547

Pine County Zoning: 320-216-4220

Maps are for informational purposes only and may not be exact. All properties sold "as is" with no guarantees. Buyers are encouraged to thoroughly research properties before purchase. If improvements are intended check with local planning and zoning authorities, and if wetlands exist contact Pine County Zoning. Acreage descriptions are approximate estimates. Please Note: Pine County makes no representations, warranties, nor guarantees with respect to access to tax forfeited lands sold. Subject to all existing easements of record and rights of way.