



**TRACT #3 BREMEN TOWNSHIP**

**PID - 05.0170.000 split**

SE ¼ of SW ¼; Timber Value \$10,000

19-44-21 40 acres

**Appraised Value: \$18,900**



**Property Description:**

A 40 acre parcel consisting of forested uplands and lowlands. Selectively logged.

Timber value \$10,000.

Property is Landlocked.

**SOLED**



[www.co.pine.mn.us](http://www.co.pine.mn.us)

**Driving Directions:**  
Property is Landlocked-NO LEGAL ACCESS

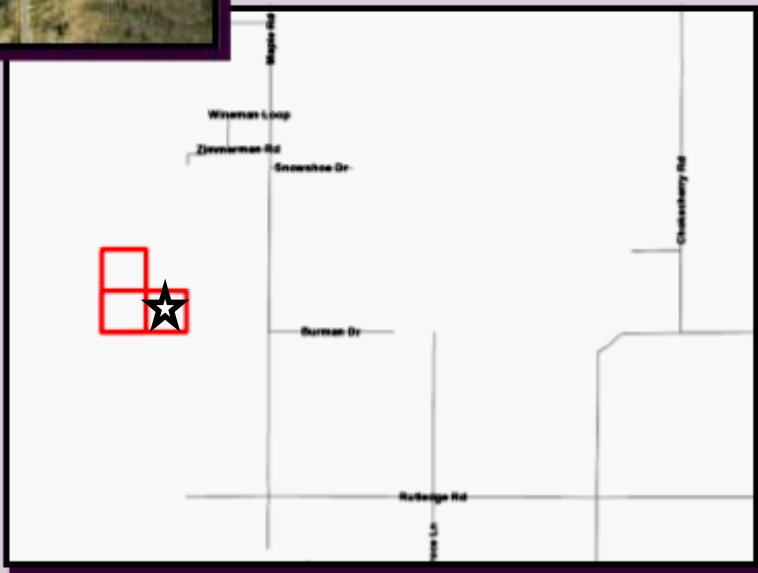

**Bremen Township: 320-279-0229**

**Pine County Zoning: 320-216-4220**

*Maps are for informational purposes only and may not be exact. All properties sold "as is" with no guarantees. Buyers are encouraged to thoroughly research properties before purchase. If improvements are intended check with local planning and zoning authorities, and if wetlands exist contact Pine County Zoning. Acreage descriptions are approximate estimates. Please Note: Pine County makes no representations, warranties, nor guarantees with respect to access to tax forfeit lands sold. Subject to all existing easements of record and rights of way.*

**For further information please contact the Pine County Land Department at 320-216-4225.**