

PLAT OF BERGMAN, PINE COUNTY, MINN.

There is a town by the name of Grant, that Christian Bergman and August Bergman, his husband, of the town of Orlingama, county of Pine, and that of Minnesota, were and heretofore of all their business being and being in said county of Pine, and state of Minnesota, and decided as follows to wit: all that tract of eastern lands in (20) in town thirty-nine (39) Range thirty-four (34) West of the fourth (20) principal meridian, beginning at a point on the north line of said section, said point being on the ground and eight (8) feet east of the north line of said section, thence running south one thousand four hundred and thirty (1433) feet; thence east and parallel to the north line of the section one hundred and eighty four (184) feet to the corner of the section; thence running westerly along the balance to the north line of said section, said section being the distance of two hundred and sixty (260) feet to the point of beginning; thence west the same to the starting, as a corner to the town as the town of Bergman and the same has been laid out for some purpose as known above; and, in so doing, by deed and deeded to the public use here, all estate and interest as known above.

In testimony whereof, the said Christian Bergman and August Bergman has his hand hereunto set this tenth day of October A. D. 1902.

Ligned, sealed and delivered
 in presence of
 } Christian C. Bergman
 } August Bergman
 } M. Bergman
 } O. N. McAllen

Date of Minnesota, 1902
 County of Pine } On this 18th day of September A. D. 1902, before me, a Notary Public, personally appeared Christian C. Bergman and August Bergman, his husband, to me known to be the persons described in the foregoing declaration, and duly acknowledged the same to be their free act and deed.

Witness my hand and official seal the day and year above written.
 O. N. McAllen,
 Notary Public, Pine County,
 Minnesota.

State of Minnesota,
 County of Pine } J. N. St. Mendelin, County Surveyor, in and for Pine County, State of Minnesota, do hereby certify that I have surveyed the land described in the foregoing declaration, and divided the same into lots, blocks and streets as shown on the annexed plat, and that all the lots and blocks are numbered in progressive numbers, and that the size of all lots, and width of the streets are indicated on said plat, by figures standing feet, and that said plat accurately represents the survey and divisions above referred to, and that in the presence of justice surveyor, I have placed monuments as follows:

- At the southeast corner of the east plat, at the southeast corner of the east plat.
 - At the southeast corner of Block 1,
 - At the northeast corner of Block 2,
 - At the southeast corner of Block 2.
- Block of said monuments being of limestone, and having a cross (+) cut on the upper face.
- Witness my hand this 11th day of June A. D. 1902.
 J. N. St. Mendelin,
 County Surveyor.

Date of Minnesota, 1902.
 County of Pine } On this 12th day of June A. D. 1902, before me personally appeared J. N. St. Mendelin, a Notary Public, personally known to be the persons described in and who executed the foregoing plat, and acknowledged that he executed the same as his free act and deed.

J. N. St. Mendelin,
 Notary Public,
 Pine County, Minn.

No. 42446
 5 Apts. 2
 3 Apts. 902
 2 Apts. 1
 James H. Mandell
 H. J. Ahndt.

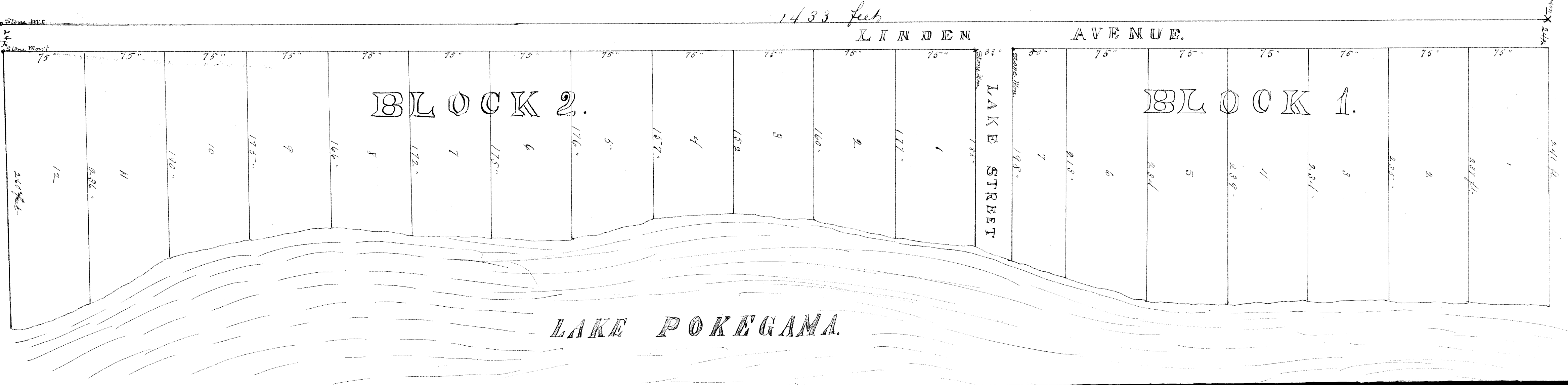
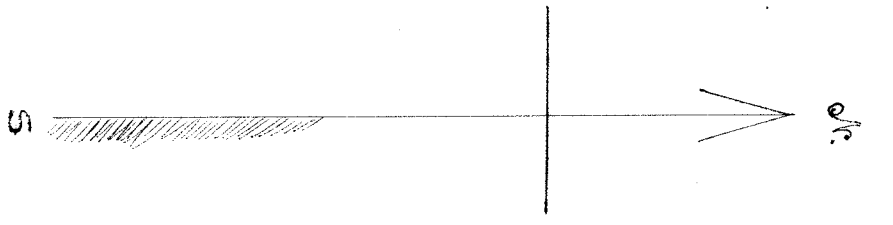

Scale: 60 ft = 1 inch.