

Markville.

Pine Co. Minn.

IN SW 1/4 NE 1/4 SEC. 26 T. 42 N. R. 16 W.

Scale 1"=100'

KNOW ALL MEN BY THESE PRESENTS, that Tri-State Land Company, a corporation organized and existing under the laws of the State of Minnesota, the owner and proprietor of that certain land situated in the County of Pine and State of Minnesota, and being all that portion of the South West 1/4 of the North East 1/4 of Section 26 Town 42 N. R. 16 W. described as follows, to-wit:

Commencing at the center of Section 26, Town 42 N. R. 16 W., Thence running East along the East and West 1/4 line of said section a distance of Four Hundred Seventy Nine and Fifty Six One Hundredth (479.56) feet to an iron monument and place of beginning. Thence East along the said East 1/4 West 1/4 line a distance of Seven Hundred Twenty Five and Eight Tenth (725.8) feet to an iron monument. Thence North at right angles a distance of Seven Hundred Seventy (770) feet to an iron monument. Thence West at right angles a distance of Six Hundred Thirteen (613) feet to an iron monument. Thence Southerly at an angle of 81°47' a distance of Seven Hundred Seventy Eight and one tenth (778.1) feet to the place of beginning.

Has caused the same to be surveyed, platted and hereafter known as Blocks One (1), Two (2), Three (3) and Four (4) of MARKVILLE, and hereby donates and dedicates to public use forever all the streets and alleys thereby shown.

IN WITNESS WHEREOF, the said Tri-State Land Company has caused these presents to be signed by E. Pennington, President, its corporate seal to be hereunto affixed and the same to be countersigned by Henry B. Dike, Secretary, this 23 day of September A.D. 1911.

In presence of
 E. M. Johnson (T.S.L.C. Corporate Seal)
 TRI-STATE LAND COMPANY,
 By - E. Pennington President,
 Countersigned Henry B. Dike Secretary.

BE IT KNOWN, that on this 23 day of September A.D. 1911, before me appeared E. Pennington and Henry B. Dike to me personally known, who each being duly sworn did say that they are the President and Secretary, respectively, of the Tri-State Land Company and that the seal affixed to the foregoing instrument is the corporate seal of said Corporation and that said instrument was signed and sealed in behalf of said Corporation by authority of its Board of Directors, and said E. Pennington and Henry B. Dike acknowledged said instrument to be the free act and deed of said Corporation.

(Notarial Seal.)

H. C. Cassady
 Notary Public Pine County, Minn.
 My commission expires June 8th 1917.

I hereby certify that I have surveyed and platted the property described in this plat as Blocks One (1), Two (2), Three (3) and Four (4) of MARKVILLE. That this plat is a correct representation of said survey, that all distances are correctly shown on the plat in feet and decimals of a foot, that all monuments for guidance of future surveys have been correctly placed in the ground as shown on the plat, that the outside boundary lines are correctly designated on the plat, that the topography of the land is correctly shown on the plat and that there are no wet lands or public highways to be designated on said plat other than as shown thereon.

Marshall Roy
 Surveyor.

STATE OF MINNESOTA } S.S.
 COUNTY OF PINE. }
 On this 21 day of Sept. A.D. 1911 personally appeared Marshall Roy, to me well known and acknowledged that he executed the foregoing certificate as his free act and deed.

(NOTARIAL SEAL.)

O. B. Fredrickson
 Notary Public Pine County, Minn.
 My commission expires July 4, 1916.

I hereby certify that the within plat of Markville was duly submitted to the Board of County Commissioners of Pine County, Minn. this 30th day of October A.D. 1911, and the same was approved by resolution duly adopted by said Board of County Commissioners.

Edward Blough
 Chairman, Board of County Commissioners,
 Pine County, Minn.

I hereby certify that an exact duplicate of the within plat of Markville was filed for record in the office of the County Auditor, County of Pine County, Minn. this 31st day of October A.D. 1911.

W. H. Hamlin
 County Auditor, Pine County, Minn.

I hereby certify that taxes for the year 1910 on lands described within are paid.

Wm. H. Bradley
 County Treasurer.

68915
 Office of Register of Deeds }
 County of Pine, Minn. }

I hereby certify that the within instrument was filed in this office for record on the 2nd day of November A.D. 1911.

at 4 o'clock P. M. and was duly recorded in Book of PLATS

page James H. Handley
 REGISTER OF DEEDS.

Taxes Paid and Transfer Entered
 this 31st day of October 1911.

W. H. Hamlin
 County Auditor.



PLAT OF
BLOCKS 5, 6 & 7.

MARSHVILLE

PINE CO MINN.
Sec 26 T. 42 N. R. 16 W
Scale 1"=150'

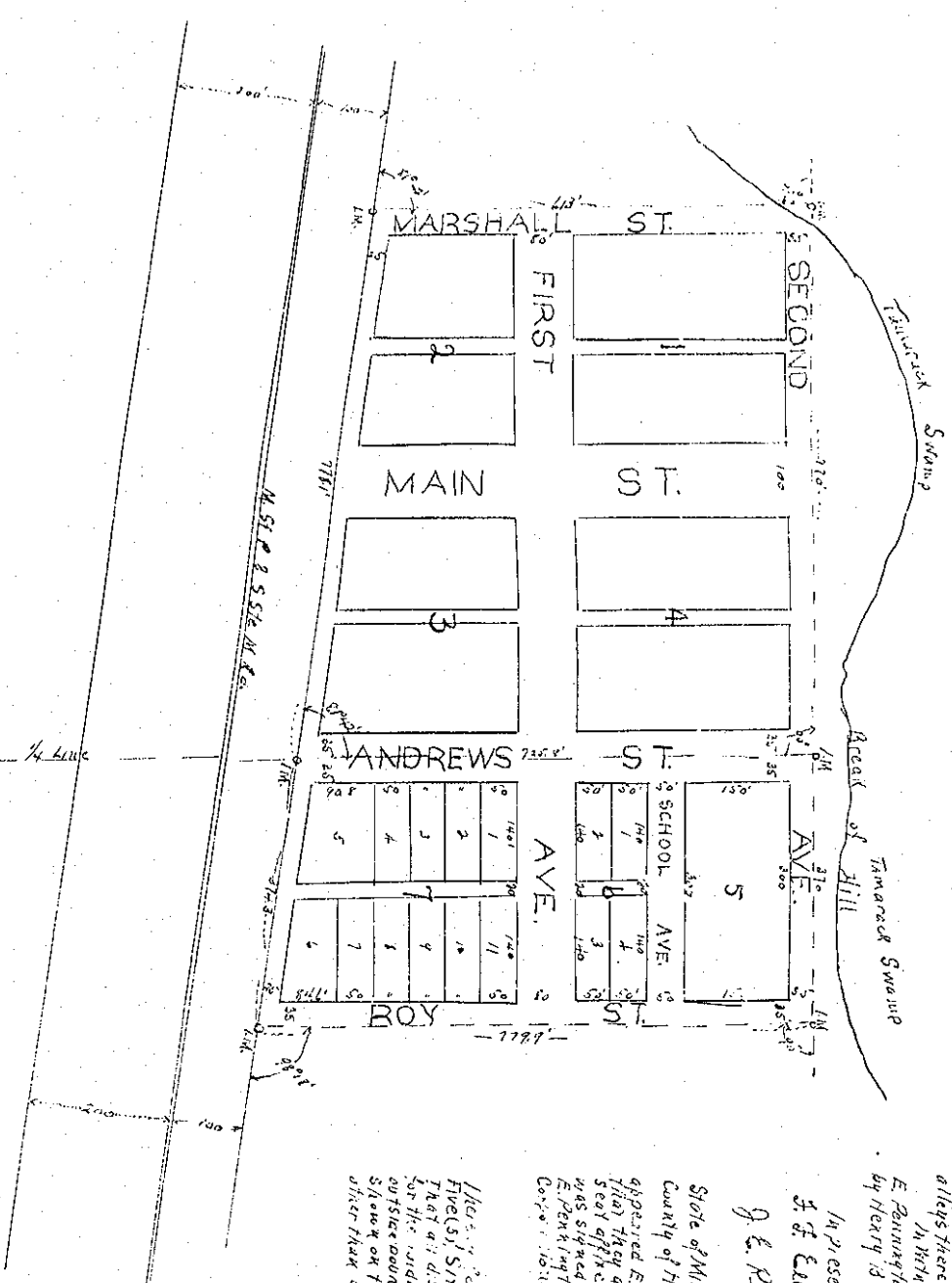

Study certify that lines for the year 1913
on labels attached under are filed
Chas. O. P. County Clerk
No. 11347
When of Register of Deeds
Blaine, Minn.
Study certify that the within instrument
was duly in this office for record on the 2nd
day of September A.D. 1914 at 5 o'clock P.M. and
and duly recorded in book of Deeds page 3
James H. Stewart
Register of Deeds

Know all men by these presents That The State Land Company a corporation organized and existing under the laws of the State of Minnesota, the owner and proprietor of that certain land situated in the County of Pine and State of Minnesota and being all that portion of Section Twenty Six (26) Town Forty Two (22) Range Sixteen (16) First District as shown on the map of the State of Minnesota East corner of the Town of Marshville as shown on the map of the State of Minnesota a distance of seven hundred twenty five and eight tenths (725.8) feet to the south line of the same town and a distance of three hundred seventy four and three tenths (374.3) feet to an iron pin with a diameter of one inch and a distance of seven hundred and seventy (770) feet to an iron horizontal and piece of bracing.

Has caused the same to be surveyed, plotted and now as shown on Block 5 (Sec. 26, T. 42 N. R. 16 W.) of Marshville, and hereby declares and certifies to public use for all the streets, avenues and alleys thereby shown.

In Witness Whereof, The said The State Land Company has caused these presents to be signed by E. Pennington, President its corporate seal to be hereunto affixed, and the same to be countersigned by Henry B. Dike, Secretary this 2nd day of August A.D. 1914.

In presence of
J. F. Edmunds
J. E. Johnson
J. S. E. (Colonial Seal)
By E. Pennington President
Countersigned Henry B. Dike Secretary

THE STATE LAND COMPANY

State of Minnesota) ss
County of Hennepin) ss
On this 25th day of August A.D. 1914 personally appeared Marshall Roy, to me well known and acknowledged that he executed the foregoing certificate as his free will and deed.

(Signed)
My commission expires March 17, 1920.
J. C. Peterson, Notary Public,
Minneapolis, Minnesota

State of Minnesota) ss
County of Hennepin) ss
On this 25th day of August A.D. 1914 personally appeared Marshall Roy, to me well known and acknowledged that he executed the foregoing certificate as his free will and deed.

(Signed)
My commission expires March 17, 1920.
J. C. Peterson, Notary Public,
Minneapolis, Minnesota

Let it be certified that I have surveyed and plotted the property described in this plat as Blocks Five (5), Six (6) and Seven (7) of Marshville, that this plat is a correct representation of said survey that all distances are correctly shown on the plat in feet and decimals of a foot that all monuments for the advance of future surveys have been correctly placed in the ground as shown on the plat that the corner boundary lines are correctly described on the plat that the topography of the land is correctly shown on the plat and that there are no wet lines on public highways to be respected on said plat other than as shown hereon.

Marshall Roy
Surveyor

Study certify that the within plat of Blocks 5, 6 & 7 of the Township of Marshville were duly submitted to the Board of County Commissioners of Pine County, Minnesota, this 15th day of September A.D. 1914, and the same was approved by resolution duly adopted by said Board of County Commissioners.

Attest Done
Blaine, Minn. Board of County Commissioners
Pine County, Minnesota

